

Overview

Parcel Number 0017322
Tax Year 2025
Class R - RESIDENTIAL
Physical Address 471 DEER RUN NC
Acreage 4.9200

Market Value 333,360
Exemption/Exclusion 0
Deferred 0
Assessed Value 333,360
Tax Rate Unavailable
Total Tax Unavailable

No Tax Disbursements

Photos & Sketches

Converted Sketch

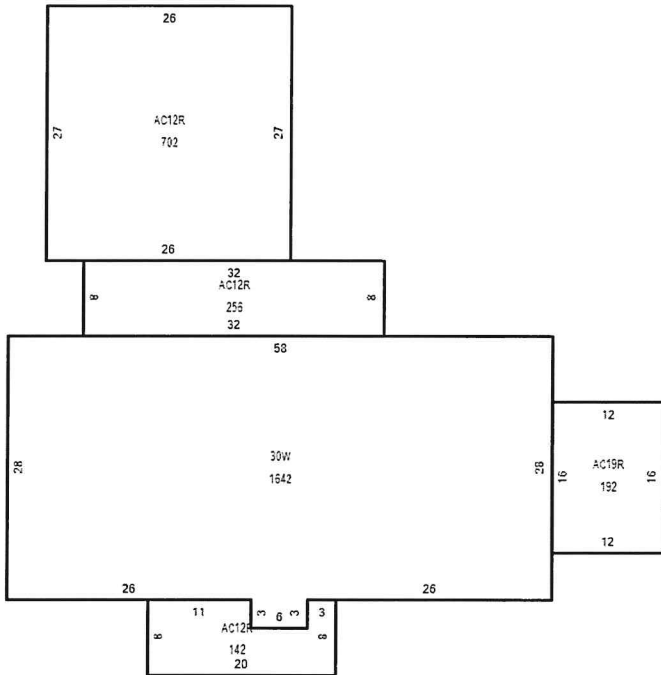

No Billing Details

☾ Tax Due Amounts

If paid in...	Amount due is...
March 2025	\$0.00
April 2025	\$0.00
May 2025	\$0.00
June 2025	\$0.00
July 2025	\$0.00
August 2025	\$0.00
September 2025	\$0.00
October 2025	\$0.00
November 2025	\$0.00
December 2025	\$0.00

Pay Taxes

Tax Due amounts are for all unpaid years.
See Payment History section for year-by-year details.

☾ Payment History

Tax Year	Total Due	Total Paid	Amount Unpaid	Date Paid
2024	\$2,052.79	\$2,052.79	\$0.00	11/21/2024
2023	\$1,962.95	\$1,962.95	\$0.00	11/29/2023
2022	\$1,883.57	\$1,883.57	\$0.00	11/17/2022
2021	\$1,861.11	\$1,861.11	\$0.00	8/11/2021
2020	\$1,592.34	\$1,592.34	\$0.00	11/13/2020

Show 5 More (22)

Zoning

Code	Classification
R-1	RESIDENTIAL DISTRICT 1
R-1	RESIDENTIAL DISTRICT 1

Legal

Legal Description	Subdivision Name	Block	Lot	Plat Book	Plat Page
LOT #16R					

No Exclusions

Owner Information

OWNER HARVEL PAUL WILSON IV,
Mailing Address 471 DEER RUN
 PITTSBORO, NC 273125437

Transfer History

Book & Page	Sale Type	Sale Date	Sold By	Sold To	Price
2282 0933	WARRANTY DEED	2/8/2022	HARVEL PAUL WILSON IV HEARNE ANN HARVEL	HARVEL PAUL WILSON IV	\$0
1849 0377	WARRANTY DEED	4/1/2016	HARVEL MARJORIE ANN CLARK	HARVEL PAUL WILSON IV HEARNE ANN HARVEL	\$0
993 0162	COMBINE	3/8/2016		HARVEL MARJORIE ANN CLARK HARVEL ANNE C	\$0
993 0162	SPLIT	6/30/2005		HARVEL MARJORIE ANN CLARK	\$0
993 0162	QUIT CLAIM DEED	2/3/2003	HARVEL MARJORIE ANN CLARK	HARVEL MARJORIE ANN CLARK	\$0
458 0433		12/31/1996		HARVEL PAUL WILSON HARVEL ANNE C	\$0

No Genealogy

Land Value

Property Class	Valued Acres	Appraised Value
Acre - Residual	3.9200	112,896
Acre - Primary	1.0000	99,000

☰ CAMA - Structure (1 of 2) - Real Estate

Property Class	Description	Total Finished Area	Year Built
RES - Residential	MANUFACTURED	1,642	1986

House Type
17 - MANUFACTURED

Porches/Decks	
AC12R - Deck - Frame	142 Square Ft.
AC12R - Deck - Frame	702 Square Ft.
AC12R - Deck - Frame	256 Square Ft.
AC17R - Porch - Screened	192 Square Ft.

Base Cost	
30W - Manufactured Home Multi	1,642 Square Ft.

Exterior Wall	
EW06 - Wood Siding	10 Percent
EW08 - Alum/Vinyl	90 Percent

Accommodations	
Number of Bathrooms	2.00
Number of Bedrooms	2.00
Number of Half Bathrooms	0.00
Number of Rooms	6.00

Fireplace	
FP03R - Prefabricated (count)	1.00

Foundation Type	
FN03 - Slab	1,642 Square Ft.

Heating & Cooling	
HC07 - Packaged Heat/Cool	1,642 Square Ft.

⊖ CAMA - Structure (2 of 2) - Real Estate

Property Class	Description	Total Finished Area	Year Built
RES - Residential	Outbuildings Only - RES	0	2023

Storage	
MS28R - Storage Bldg. Unfinished	630 Square Ft. Year Built: 2000
MS28R - Storage Bldg. Unfinished	160 Square Ft. Year Built: 1995

Carport/Garage	
MS81R - Car Pole Shed - Metal	630 Square Ft. Year Built: 1995

Shed	
MS23R - Shed Open Pole	144 Square Ft. Year Built: 1995
MS48R - Lean-to/Shelter	128 Square Ft. Year Built: 1995

⊖ Market Value

Year	Market Land	Market Building	Market Total
2025	211,896	121,464	333,360
2024	123,120	101,474	224,594
2023	123,120	101,474	224,594

⊕ Map

[View Full Screen](#)

Contact Information

Chatham County Tax Assessor

12 East Street
 PO Box 908
 Pittsboro, NC 27312
 Phone: 919-542-8211

Chatham County Tax Collector

192 West Street
 PO Box 697
 Pittsboro, NC 27312
 Phone: 919-542-8260