

JUNEAU COUNTY CERTIFIED SURVEY MAP NO. _____

TOTAL PAGES: 2
MAP # 5166

ASR SURVEYING

N 2169 SHINKLE HILL RD.
MAUSTON WI. 53948
608-547-3012
PROJECT # 24206

PART OF LOT 2, JUNEAU COUNTY CERTIFIED SURVEY MAP #5131,
DOCUMENT #760799, LOCATED IN THE NE1/4 NW1/4 OF SECTION 27,
T. 18N., R. 3E., TOWN OF NECEDAH, JUNEAU COUNTY, WISCONSIN

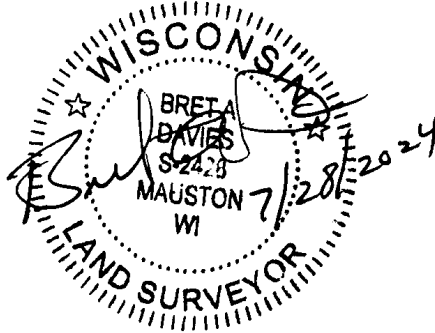

SURVEYOR'S CERTIFICATE

I, BRET A. DAVIES, Professional Land Surveyor, hereby certify;

That I have surveyed and mapped part of Lot 2, Juneau County Certified Survey Map #5131, recorded as Document #760799, being located in the NE1/4 NW1/4 of Section 27, T. 18N., R. 3E., Town of Necedah, Juneau County, Wisconsin, Bounded by the following described line;

Commencing at the North 1/4 corner of said Section 27; thence S89°40'47"W, 861.37 feet along the north line of said Section 27 to the POINT OF BEGINNING.

Thence S00°37'01"E, 649.76 feet; thence S38°50'18"E, 532.56 feet; thence S89°43'52"W, 472.36 feet; thence S00°39'36"E, 254.01 feet to the south line of said Lot 2, Certified Survey Map #5131; thence S89°43'52"W, 331.01 feet along said south line to the forty corner; thence N00°39'36"W, 1319.74 feet along the west line of said Lot 2 to the northwest corner of said NE1/4 NW1/4; thence N89°40'47"E, 474.66 feet to the POINT OF BEGINNING.

Said parcel contains 15.11 Acres

That I have made such survey and map at the direction of Secluded Lands, LLC;

That such map is a correct representation of the exterior boundaries of the lands surveyed;

Subject to all easements, restrictions, reservations, and rights-of-way of record;

That I have fully complied with 236.34 of the Wisconsin Statutes, Section AE 7 of the Wisconsin Administrative Code and Chapter 23 of Juneau County Ordinances, in surveying, dividing, and mapping the same, to the best of my knowledge and belief.

LAND, FORESTRY, PARKS, AND ZONING COMMITTEE APPROVAL

This Certified Survey Map is hereby approved by the Land, Forestry, Parks, and Zoning.

Zoning Administrator
David M. Donnelly
Date 7-31-24

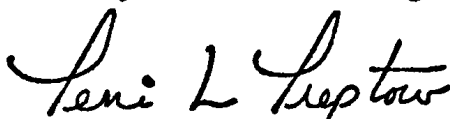
County Clerk
Date 8-9-24

