

- - IRON PIPE FOUND
- - IRON PIN FOUND
- - IRON PIN SET

REVISED 5-19-79
REVISED 7-18-79

PLAT SHOWING SURVEY OF A PORTION OF THE PROPERTY OF PAULINE M. WINSLOW, SITUATED NEAR ROUTE 10, CHUCKATUCK BOROUGH, CITY OF SUFFOLK, VIRGINIA, SCALE 1" = 100' FEBRUARY 28, 1978 SURVEYED BY G. R. JENKINS LAND SURVEYOR NO. 1236 SUFFOLK, VIRGINIA

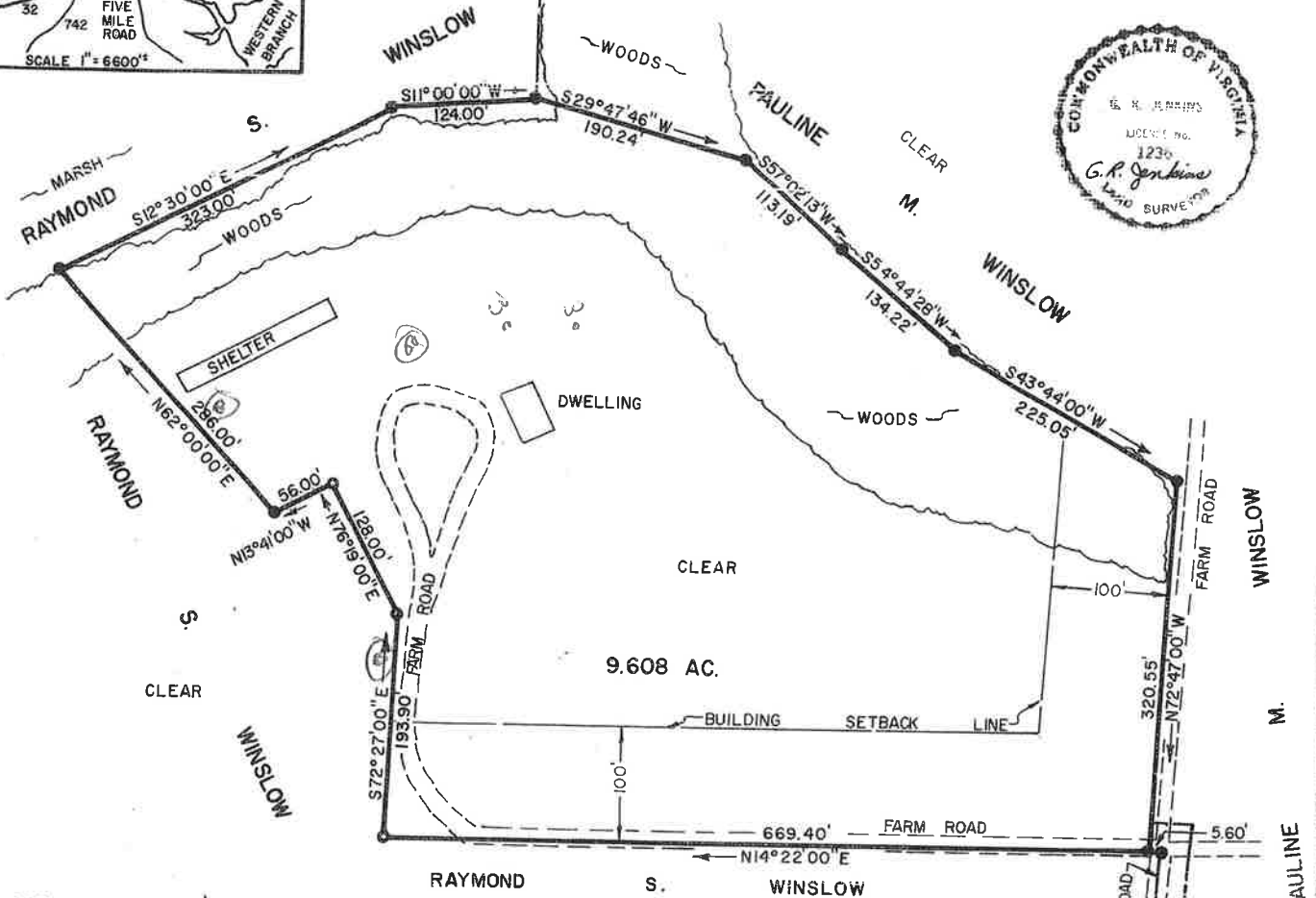

REF.-TAX MAP 18 PARCEL 10 D.B. 335 PG. 361 P.B. 17 P.G. 17

I HEREBY CERTIFY THAT THIS SUBDIVISION WAS MADE BY ME AT THE DIRECTION OF THE OWNERS AND THAT THIS SUBDIVISION IS ENTIRELY WITHIN THE BOUNDARIES OF LAND OWNED BY THEM AND THAT STEEL PINS, AS SHOWN ON THIS PLAT BY SMALL CIRCLES, HAVE ACTUALLY BEEN PLACED AND THEIR LOCATIONS CORRECTLY SHOWN

DATE July 19, 1979

G. R. Jenkins LAND SURVEYOR

THIS SUBDIVISION OF PROPERTY AS IT APPEARS ON THIS PLAT IS WITH THE FREE CONSENT AND IN ACCORDANCE WITH THE DESIRES OF THE UNDERSIGNED OWNER. THE TITLE TO THIS PROPERTY IS RECORDED IN DEED BOOK 335 PAGE 361. DATE 7/29/79 Pauline M. Winslow OWNER

STATE OF VIRGINIA
CITY OF SUFFOLK TO WIT:

I, J. Samuel Glasscock, A NOTARY PUBLIC IN AND FOR THE CITY AND STATE AFORESAID DO HEREBY CERTIFY THAT THE ABOVE PERSON WHOSE NAME IS SIGNED TO THE FOREGOING WRITING HAS ACKNOWLEDGED THE SAME BEFORE ME IN MY CITY AND STATE AFORESAID. GIVEN UNTO MY HAND THIS 20th DAY OF July, 1979. MY COMMISSION EXPIRES September 19, 1979

J. Samuel Glasscock
NOTARY PUBLIC

THE UNDERSIGNED CERTIFY THAT THIS SUBDIVISION AS IT APPEARS ON THIS PLAT, CONFORMS TO THE APPLICABLE REGULATIONS RELATING TO THE SUBDIVISION OF LAND AND IS ACCORDINGLY APPROVED, BY SUCH APPROVAL, THE UNDERSIGNED DO NOT CERTIFY AS TO THE CORRECTNESS OF THE STREETS, BOUNDARIES, OR OTHER LINES AS SHOWN ON THIS PLAT. NEITHER THE CITY OF SUFFOLK NOR THE VIRGINIA DEPARTMENT OF HIGHWAYS AND TRANSPORTATION WILL HAVE ANY RESPONSIBILITY IN THE MAINTENANCE OF THE EASEMENT SHOWN ON THIS PLAT.

James H. Vacalis
AGENT - CITY OF SUFFOLK, VIRGINIA
July 24, 1979

6.0 MI± TO DOWNTOWN SUFFOLK
ROUTE 10 GODWIN BLVD. (50')